

NOTES:
 1. DUE TO OUR CONTINUOUS IMPROVEMENT PROGRAM, ALL MODELS AND SPECIFICATIONS ARE SUBJECT TO CHANGE WITHOUT NOTICE.

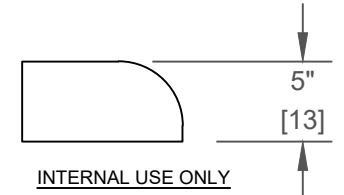
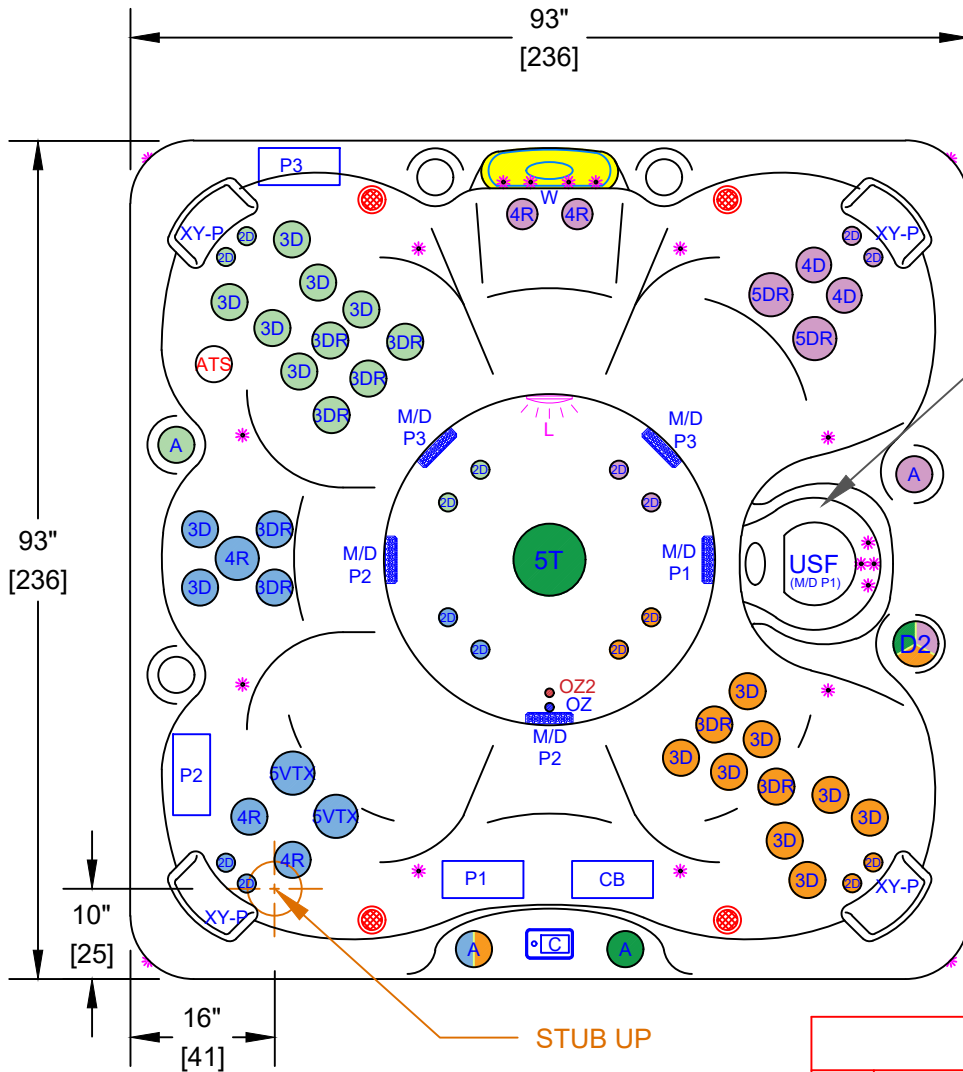

FILTER LID

	PUMP 1
	PUMP 2
	PUMP 3
	PUMP 1
	PUMP 2
	PUMP 3
	CONTROL BOX

EC-851BX - LEGEND			
SYMB.	DESCRIPTION	PART NUMBER	QTY.
2D	2" CLUSTER STORM DIRECTIONAL VECTOR X	PLUCS2440019S-HLG	16
3D	3" MINI STORM DIRECTIONAL VECTOR X	PLUCS2445009SS-HLG	14
3M	3" MINI STORM MASSAGE DIRECTIONAL VECTOR X	PLUCS2445059S-HLG	2
3DR	3" MINI STORM TWISTER VECTOR X	PLUCS2441049S-HLG	8
4D	4.5" POLY STORM DIRECTIONAL VECTOR X	PLUCS2446009SS-HLG	2
4R	4.5" POLY STORM ROTO VECTOR X	PLUCS2446039SS-HLG	5
5R	5" POWER STORM ROTO VECTOR X	PLUCS2247029S-HLG	2
5DR	5" POWER STORM TWISTER VECTOR X	PLUCS2447049SS-HLG	2
5T	5" ADJUSTABLE WHIRLPOOL VECTOR X WITH VALVE	PLUCS2394029S-HLG	1
D2	VECTOR X 2" WATER DIVERTER VALVE	CS8053609-CDHL	1
A	VECTOR X AIR CONTROL VALVE	CS6603209-CDHL	4
W	LED WATERFALL		1
USF	75 SQ. FT. ULTRA SKIM FILTER	517-4619LC-HLG	1
M/D	5" MAIN DRAIN 2.5"S	PLU644-5419-HLG V	5
XY-P	TEXTURED Y-PILLOW (WHITE)		4
C	TOUCH CONTROL+ 1001		1
OZ	PURE SILK OZONATOR WITH MAZZIE INJECTOR AND MIXING CHAMBER		1
P1, P2, P3	HIGH PERFORMANCE PUMP 6.0 BHP		3
CB	CONTROL BOX WHISPER HOT™ HEATING SYSTEM		1
	ELITE III SPOTLIGHT 4x CABINET CORNERS		1
	5" MULTI COLORED LED LIGHT		1
	PERIMETER LED LIGHTING		1
-	EXTERIOR LED CAL SPAS LOGO		1
-	FILTER LID (SINGLE FLT)	FIL11300260	1

OPTIONS		
SYMB.	DESCRIPTION	OPTION NUMBER
-	CAL SPAS THROTTLE SEAT WITH VARIABLE SPEED PUMP	OPT25-108FLX N/A WITH OPT25-113S
ATS	EXCLUSIVE ADJUSTABLE THERAPY SYSTEM WITH FLOOR JETS	OPT25-109 N/A WITH OPT25-112C
	COOLER SEAT UPGRADE (INCLUDES BLOWER + 8 AIR JETS)	OPT25-107CRS
-	TWIN PURE SILK SYSTEM DIAL OZONATORS WITH MAZZIE INJECTORS AND MIXING CHAMBERS	OPT25-102DX-1
-	BALBOA EQUIPMENT WITH XL HEATER BP501X w/TOUCH 2 TOPSIDE	OPT25-139BP-3
-	PURE CURE UV PURIFICATION SYSTEM	OPT25-191B
	24/7 FILTRATION SYSTEM	OPT25-112C N/A WITH OPT25-109
-	CAL RIDGE CABINET w/SMOOTH CORNERS & LED PERIMETER CABINET LIGHTING	OPT25-983CR-8
-	ABS MOLDED BOTTOM TRAY	OPT25-990-8
-	CAL CONNECT RF MODULE	OPT25-168RF
	FREEDOM SOUND SYSTEM BLUETOOTH, POWERED SUBWOOFER AND 4X SPEAKERS	OPT25-FS43
-	THERMO-GUARD FULL FOAM	OPT25-900

PROPRIETARY AND CONFIDENTIAL THE INFORMATION CONTAINED IN THIS DRAWING IS THE SOLE PROPERTY OF CAL SPAS. ANY REPRODUCTION IN PART OR AS A WHOLE WITHOUT THE WRITTEN PERMISSION OF CAL SPAS IS PROHIBITED.		 CAL SPAS INC. 1462 EAST NINTH STREET, POMONA, CA 91766	
SPECIFICATIONS		TITLE	JET LAYOUT - STD
DIMENSION (in)	93"x93"x40-1/2"	LINE	ESCAPE X-SERIES
DIMENSION (cm)	236x236x100	MODEL	2025 SPA LINE BEL AIR
DRY WEIGHT	900 LBS [408 Kg]	NUM	EC-851BX
FILLED WEIGHT	4650 LBS [2109 Kg]	DWG NO.	CS003355
		REV	B
WATER CAP.	450 GAL [1703 L]	SCALE	NTS
			SHEET 1 OF 1